



Artists Impression - Indicative Only



Artists Impression - Indicative Only

AREA SCHEDULE - TENANCIES

NAME	AREA
TENANCY 1	263 m ²
TENANCY 2	260 m ²
TENANCY 3	275 m ²
TOTAL	799 m ²

Proposed Plan - Indicative Only

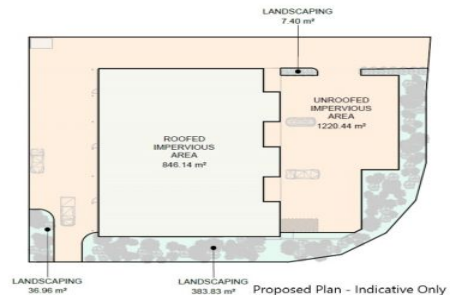
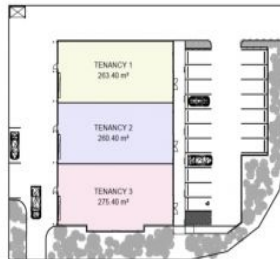

Proposed Plan - Indicative Only

83 Johanna Bvd KENSINGTON QLD

19 🚗

Welcome to 83 Johanna Boulevard, construction commencing soon so now is the time to secure your space with many options for you to choose from.

Option 1: The whole building offering an area of about 799 m².

Option 2: Take one of three individual spaces, 263m², 260m² or 275m².

Option 3: Join 2 together - from 523m².

- ? Tilt Slab construction
- ? 4.5m high roller doors to rear
- ? Easy access to loading area at the back of property
- ? Good signage available for each tenancy
- ? Plenty of parking and easy access
- ? Move in late 2024

Price : From \$220 per m² + GST and Outgoings
Land Size : 2497 sqm
View : <https://www.thefourwalls.com.au/lease/qld/bundaberg-wide-bay/kensington/commercial/showroomsbulky-goods/7896166>



John Pappalardo
07 4154 7788



Brant Duff
07 4154 7788